

Model	Rated Voltage	No Load		Rated Load				l	A B	C
		Current	Speed	Load	Current	Speed				
	V <sub>dc</sub>	mA	min <sup>-1</sup>	mN·m	mA	min <sup>-1</sup>				
F117	1.5	200	7000	1.0	700	6000	CW	8.8	<sup>18</sup> M23	3.5
F299	2.4	75	3900	1.5	370	3000	CW	7.6	<sup>18</sup> M23	3.5
F384	6.0	60	7100	2.3	350	5500	CW	7.6	<sup>18</sup> M23	3.5
F623	12.0	30	5500	1.5	120	4500	CW	8.8	<sup>18</sup> M23	3.5
F763	17.0	8	1900	1.0	20	1200	CCW	14.8	<sup>18</sup> M25	4.7
F578	24.0	6	2000	1.0	15	1200	CCW	10.5	<sup>18</sup> M25	4.7

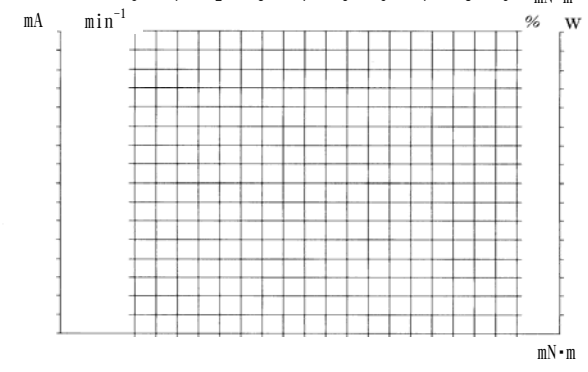

Model	Rated Voltage	No Load		Rated Load					
		Current	Speed	Load	Current	Speed			
		mA	min <sup>-1</sup>	mN·m	mA	min <sup>-1</sup>		<i>l</i>	
FH112	1.2	300	7200	0.8	800	6700	CW	5.5	
FH205	2.4	110	6500	0.8	320	5900	CW	5.5	
FH288	3.6	150	8000	1.5	500	7100	CW	9.6	※ 32 → 33
FH358	6.0	50	4000	2.0	200	3000	CW	9.6	※ 32 → 33
FH486	12.0	50	7100	2.0	180	6000	CW	5.3	※ 32 → 33
FH541	24.0	30	8500	2.0	120	7500	CW	9.6	※ 32 → 33

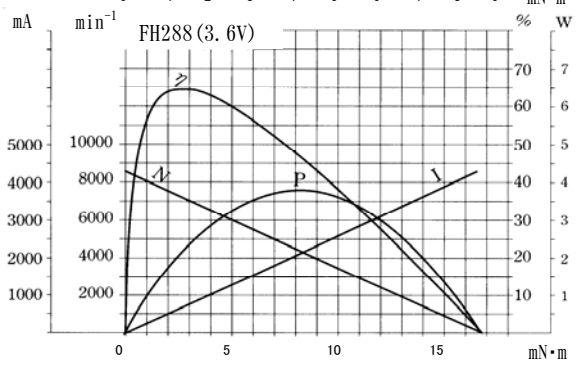
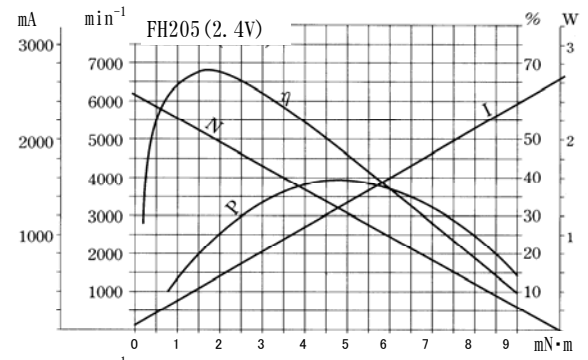
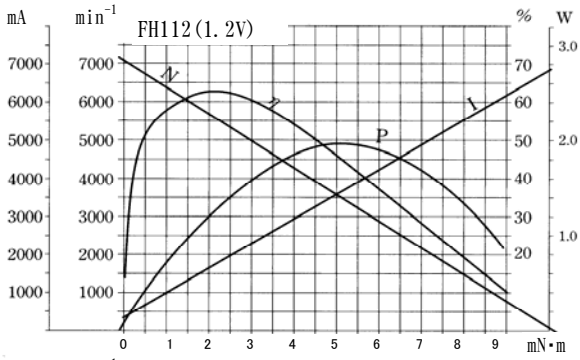
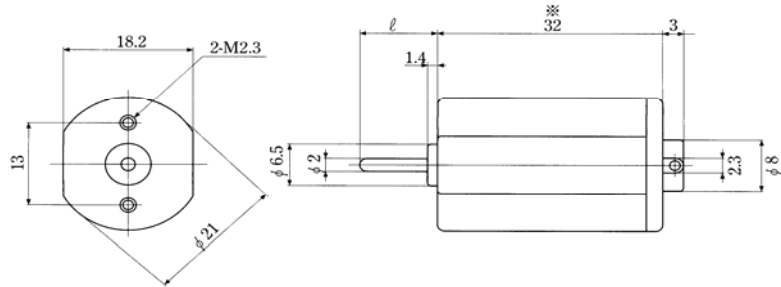
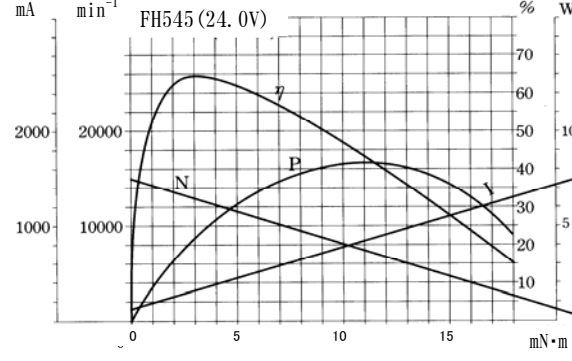
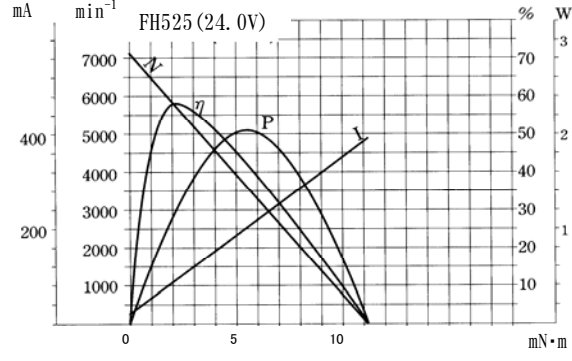
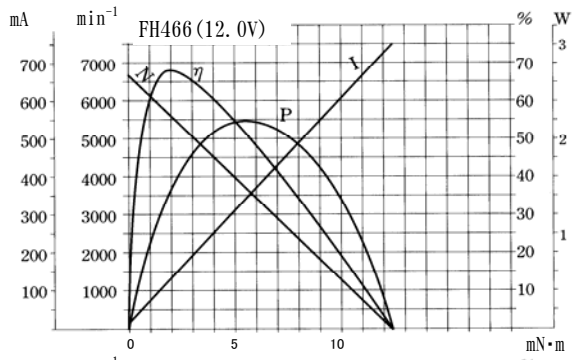
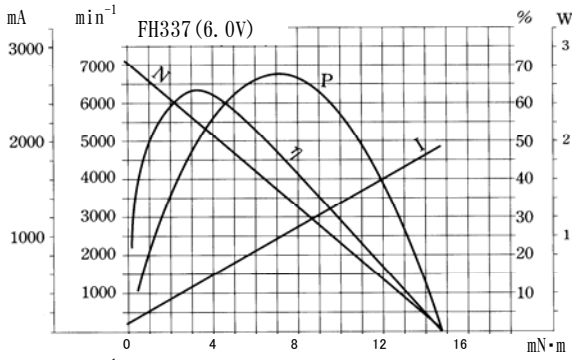
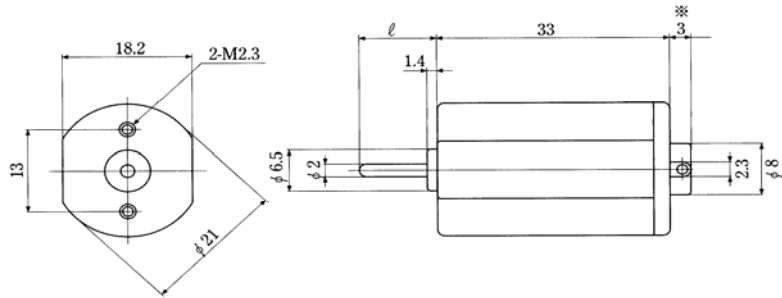

Model	Rated Voltage	No Load		Rated Load			CW	ℓ	※
		Current	Speed	Load	Current	Speed			
	V <sub>dc</sub>	mA	min <sup>-1</sup>	mN·m	mA	min <sup>-1</sup>			
FH337	6.0	90	7200	2.0	340	6200		9.6	
FH466	12.0	70	6750	3.0	280	5150		8.5	5.5
FH430	14.0	50	6200	3.0	200	4600		9.5	5.5
FH525	24.0	25	7200	2.6	110	5500		8.5	5.5
FH545	24.0	60	15400	2.0	200	14000		8.5	5.5
FH594	24.0	25	4000	1.0	45	3400		9.6	

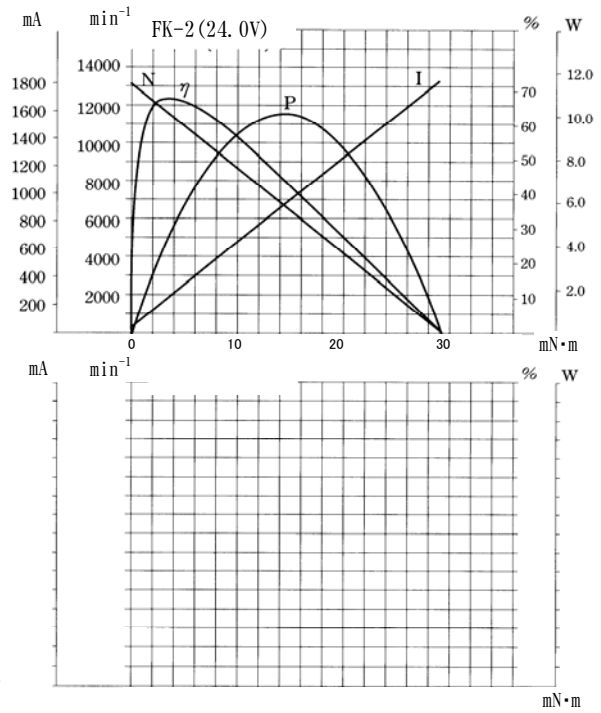
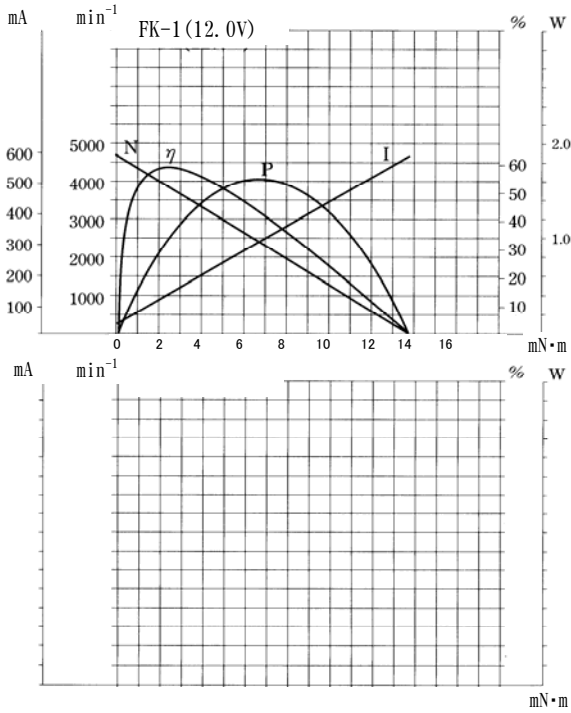
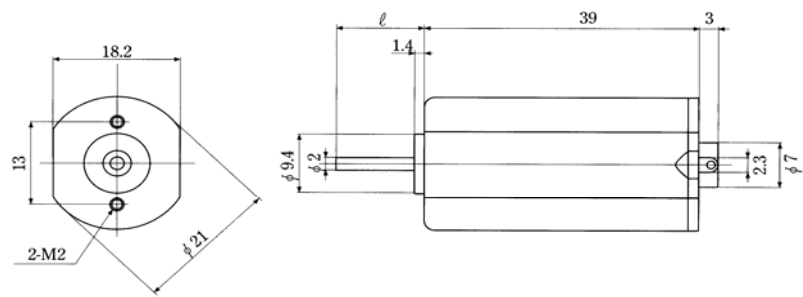

Model	Rated Voltage V <sub>DC</sub>	No Load		Rated Load			CW	ℓ
		Current mA	Speed min <sup>-1</sup>	Load mN·m	Current mA	Speed min <sup>-1</sup>		
FK-1	12.0	50	4700	4.0	240	3300		13.0
FK-2	24.0	70	13300	6.0	450	10600		8.3

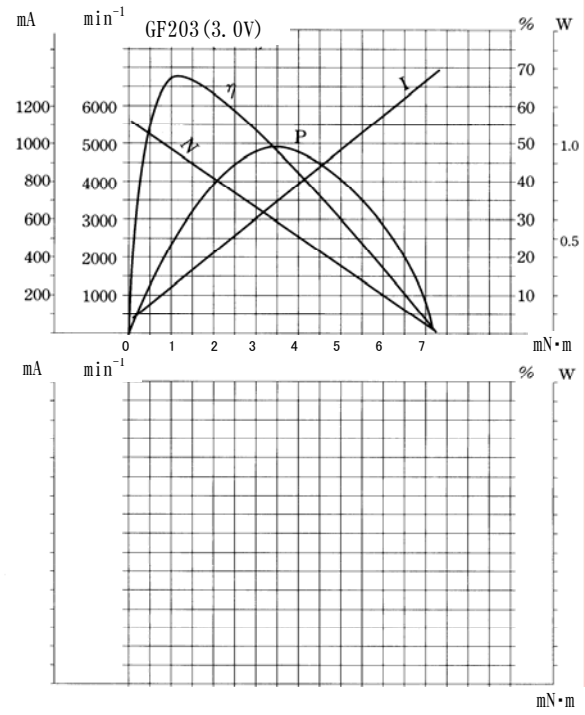
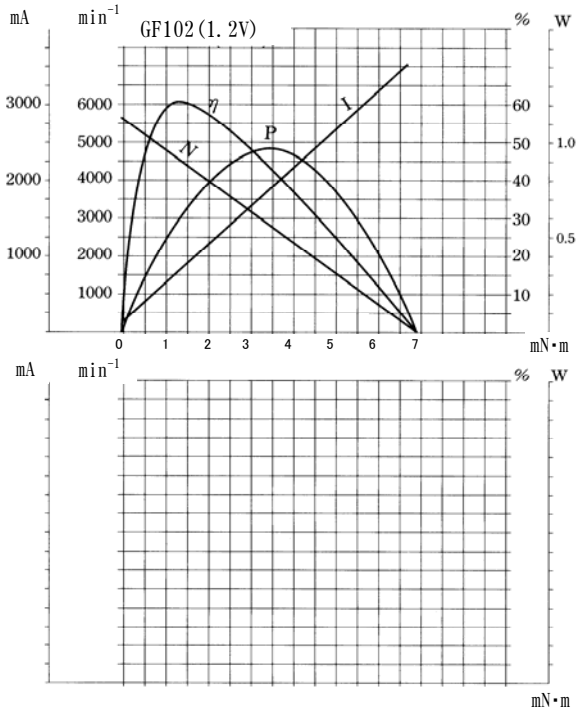
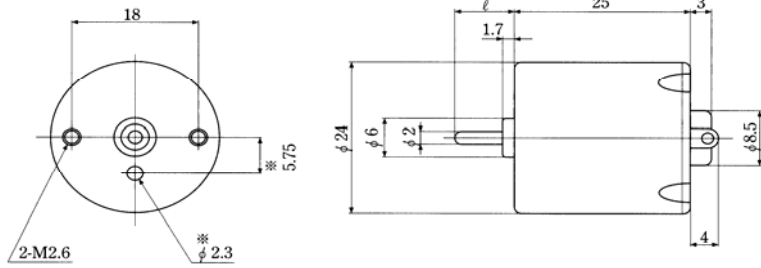

Model	Rated Voltage VDC	No Load		Rated Load			CW	ℓ	
		Current mA	Speed min <sup>-1</sup>	Load mN·m	Current mA	Speed min <sup>-1</sup>			
GF102	1.2	180	5800	0.8	560	5100		7.8	
GF206	2.4	100	5500	1.5	480	4200		9.5	
GF203	3.0	60	5500	1.5	350	4200		9.5	※別仕様

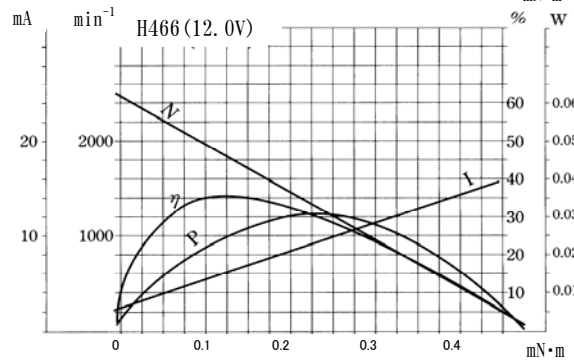
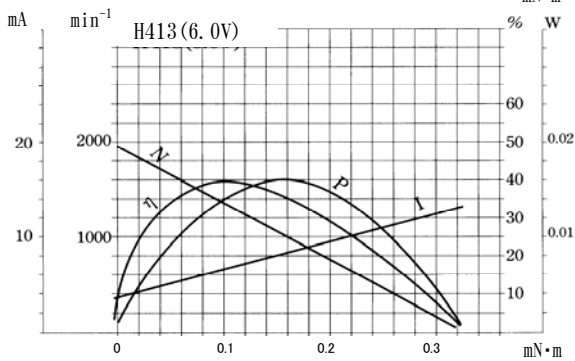
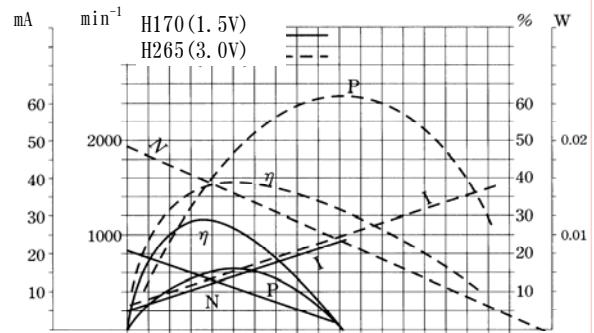
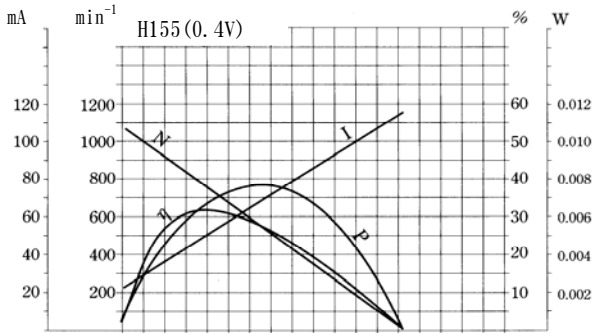
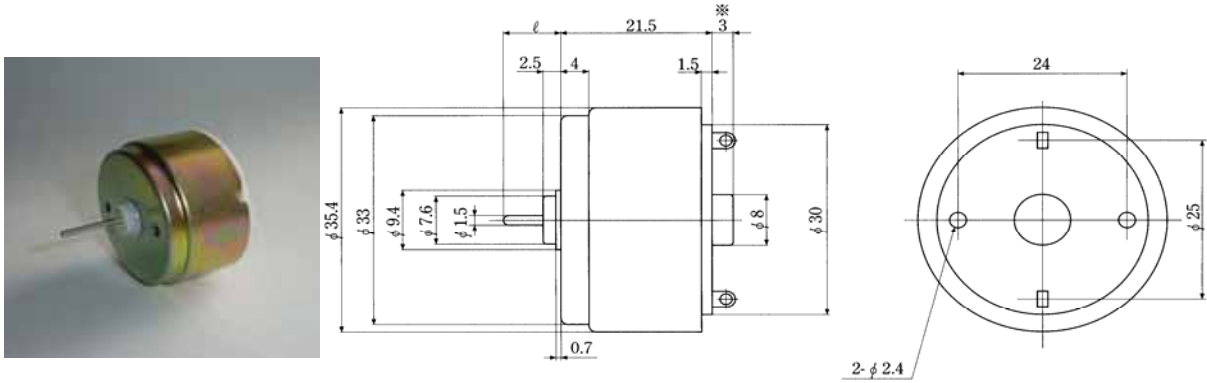

Model	Rated Voltage V <sub>DC</sub>	No Load		Rated Load			Mounting Tap	Terminal Pitch	Notes	
		Current mA	Speed min <sup>-1</sup>	Load mN·m	Current mA	Speed min <sup>-1</sup>				
H155	0.4	36	1050	0.1	70	650	CW	10.7	2 M26	
H170	1.5	4	870	0.1	12	570	CW	15.7	2 M26	
H265	3.0	7	1900	0.05	11	1900	CW	13.6	ナシ	端子 ℓ=7.2
H413	6.0	3	1900	0.05	9	1600	CW	6.2	ナシ	
H466	12.0	2	2300	0.05	7	2000	CW	13.6	ナシ	端子 ℓ=7.2

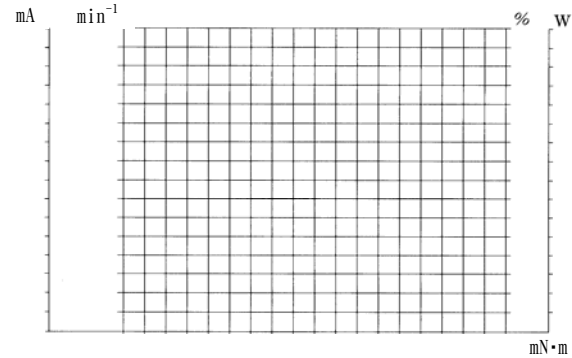
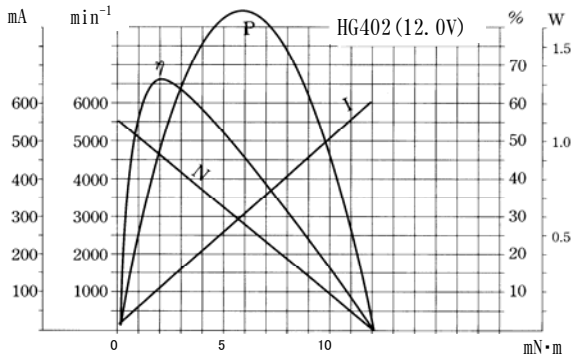
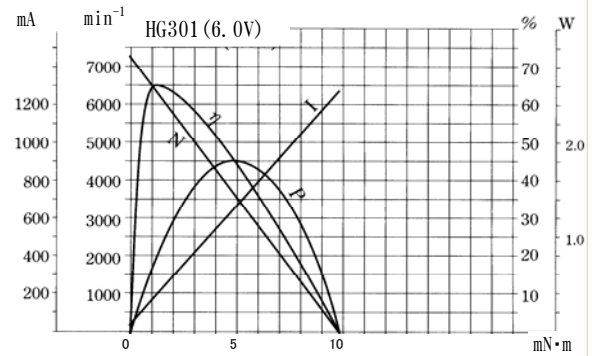
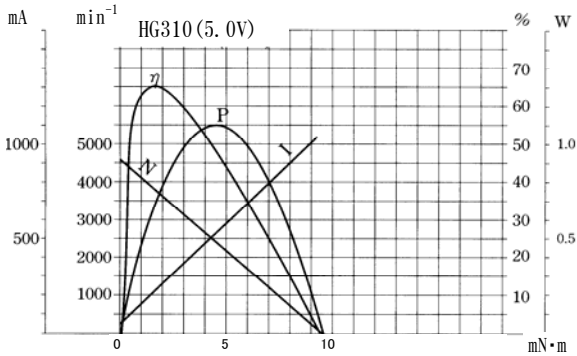
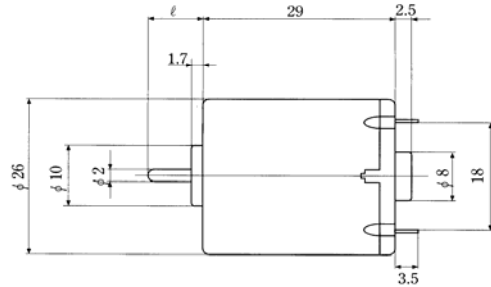
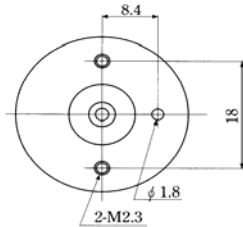

Model	Rated Voltage	No Load		Rated Load				
		Current	Speed	Load	Current	Speed		
	V <sub>dc</sub>	mA	min <sup>-1</sup>	mN·m	mA	min <sup>-1</sup>	ℓ	
HG310	5.0	45	4750	3.0	350	3050	CCW	10.0
HG301	6.0	55	7000	2.3	340	5600	CW	7.6
HG402	12.0	24	5500	3.8	210	3700	CCW	9.2



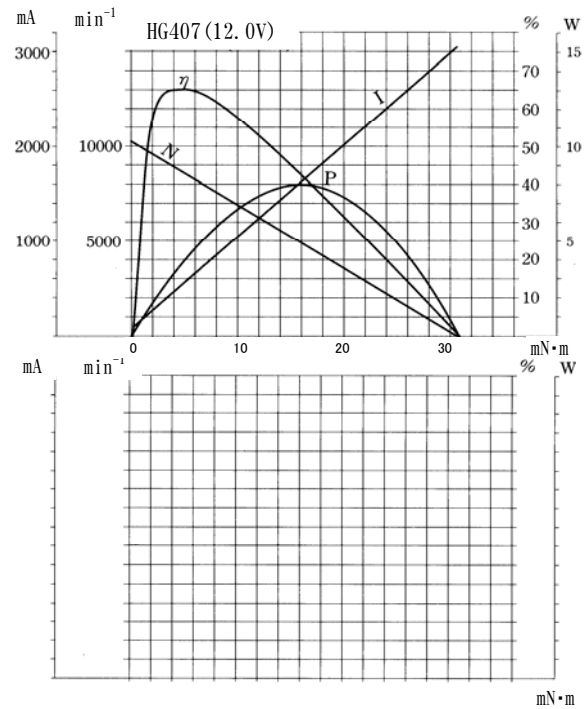
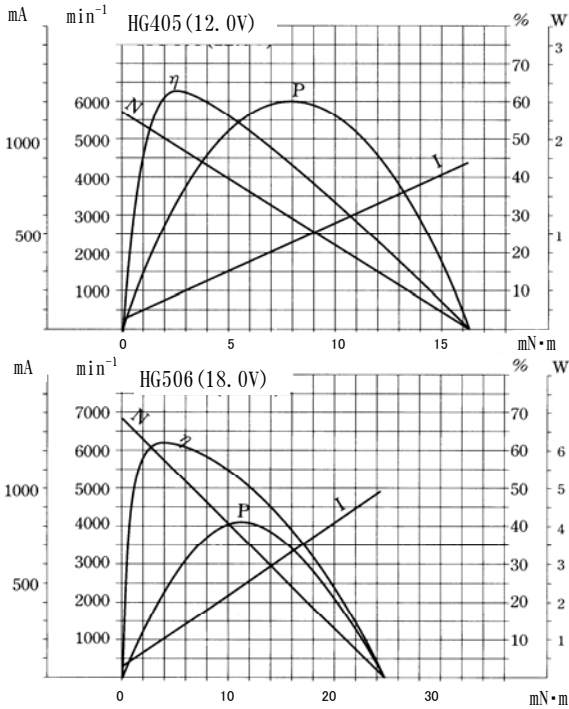
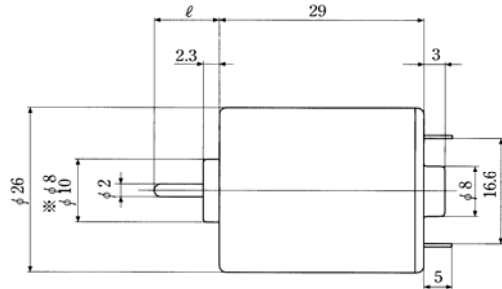
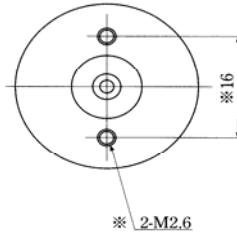

Model	Rated Voltage V <sub>DC</sub>	No Load		Rated Load			CW	ℓ	
		Current mA	Speed min <sup>-1</sup>	Load mN·m	Current mA	Speed min <sup>-1</sup>			
HG405	12.0	40	5700	5.0	300	3800	CW	10.5	
HG407	12.0	110	10000	5.5	550	8400	CW	8.0	※ 両軸別途
HG506	18.0	50	6900	5.5	270	5300	CW	8.0	※ 両軸別途
HG514	24.0	100	12000	4.0	350	10000	CW	9.0	



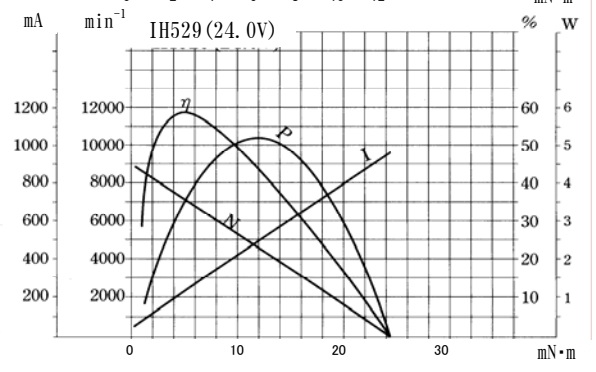
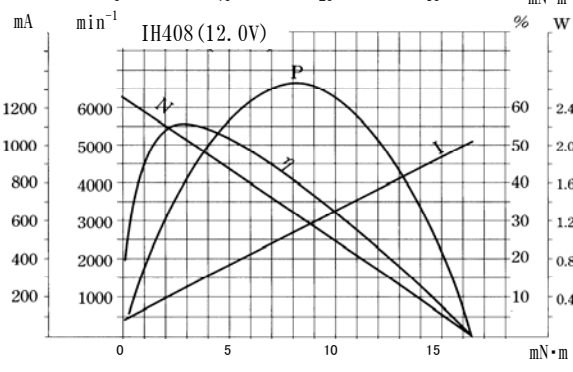
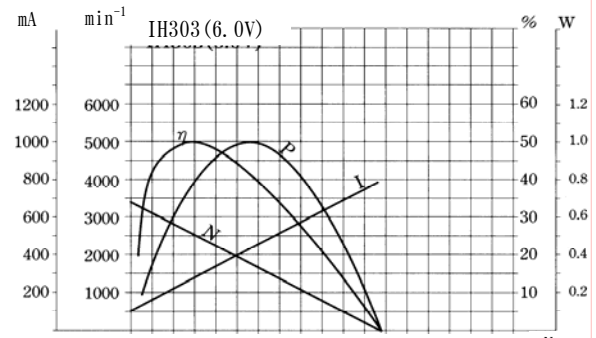
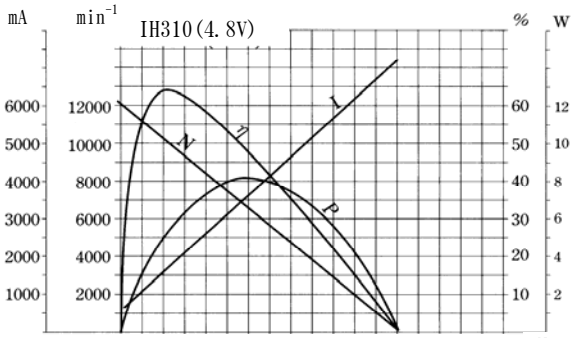
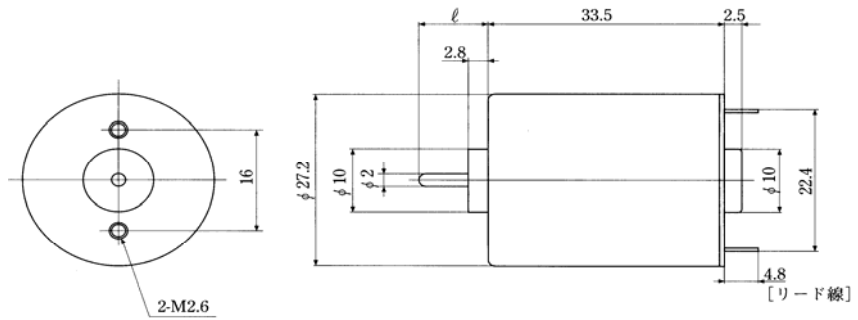

Model	Rated Voltage Vdc	No Load		Rated Load				
		Current mA	Speed min <sup>-1</sup>	Load mN·m	Current mA	Speed min <sup>-1</sup>		
IH218	3.6	350	8800	3.0	1000	7500	CCW	12.0
IH310	4.8	380	12000	2.0	930	11000	CCW	13.8
IH303	6.0	76	3400	1.0	130	3000	CCW	20.8
IH408	12.0	80	6200	2.0	200	5500	CCW	13.8
IH511	17.0	28	3200	1.0	50	2750	CCW	13.8
IH529	24.0	70	8300	5.0	300	6500	CCW	13.8